

RVT series

+105°C, Standard, Lead Free Reflow Soldering

对应无铅焊接, +105°C标准品



◆ FEATURES

- For standard.
- Life 2000 hours at +105°C.
- Available for high density mounting
- RoHS Compliant and lead-free.

◆ SPECIFICATIONS

Items	Characteristics								
Category Temperature Range	-55~+105°C								
Rated Voltage Range	6.3~100V.DC								
Nominal Capacitance Range	0.1~6800 μF								
Capacitance Tolerance	±20%(120Hz,+20°C)								
Leakage Current(MAX, 20°C)	I=0.01CV or 3uA, whichever is greater. after 2 minutes with rated working voltage								
Dissipation Factor(MAX) Tan δ (20°C, 120Hz)	Rated Voltage(V)	6.3	10	16	25	35	50	63	100
	Tan δ (Max)	0.30	0.24	0.20	0.16	0.14	0.12	0.12	0.10
When nominal capacitance is over 1000 μF, tan δ shall be added 0.02 to the listed value with Increase of every 1000 μF									
Load Life	After applying rated voltage with max ripple current for 2000hrs at 105°C, the capacitors shall meet the following requirements								
	Capacitance Change	Within ±25% of the initial value							
	Dissipation Factor	Not more than 200% of the specified value							
	Leakage Current	Not more than the specified value							
Low Temperature Stability Impedance Rate(MAX) (120Hz)	Rated Voltage(V)	6.3	10	16	25	35	50	63	100
	Z-25°C/Z+20°C	4	3	2	2	2	2	2	2
	Z-40°C/Z+20°C	10	8	6	4	3	3	3	4

◆ RIPPLE CURRENT MULTIPLIER

Frequency(Hz)	50	120	300	1K	10K~
Coefficient	0.70	1.00	1.17	1.36	1.50

◆ CASE SIZE TABLE

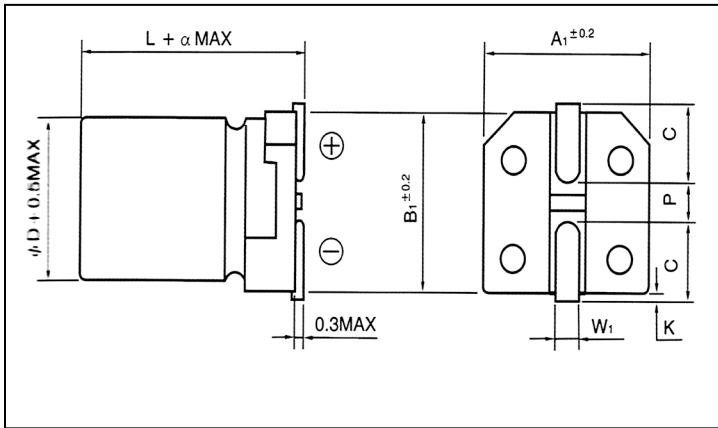

ϕD	L	A1	B1	C	W1	P	K	α
4	5.4	4.3	4.3	1.8	0.5~0.8	1.0	0.5max	0.5
5	5.4	5.3	5.3	2.2	0.5~0.8	1.3	0.5max	0.5
6.3	5.4	6.6	6.6	2.7	0.5~0.8	1.8	0.5max	0.5
6.3	7.7	6.6	6.6	2.7	0.5~0.8	1.8	0.5max	0.5
8	6.5	8.3	8.3	3.4	0.5~0.8	2.2	0.5max	0.5
8	10.2	8.3	8.3	2.9	0.8~1.1	3.1	0.5max	0.5
10	10.2	10.3	10.3	3.2	0.8~1.1	4.5	0.5max	0.5
10	13.5	10.3	10.3	3.2	0.8~1.1	4.5	0.7±0.4	0.5
12.5	13.5	13.0	13.0	4.9	0.8~1.1	4.5	0.7±0.4	0.5
12.5	16.0	13.0	13.0	4.9	0.8~1.1	4.5	0.7±0.4	0.5
16	16.5	17.0	17.0	6.0	1.0~1.6	6.8	0.7±0.4	0.5
18	16.5	19.0	19.0	6.8	1.0~1.6	6.8	0.7±0.4	0.5

◆ STANDARD RATINGS

Size: $\phi D \times L$ (mm), Ripple Current(mA r.m.s/105°C, 120Hz)

WV (μF)	6.3V (OJ)		10V (1A)		16V (1C)		25V (1E)		35V (1V)		50V (1H)		63V (1J)		100V (2A)	
	Size	R.C	Size	R.C	Size	R.C	Size	R.C	Size	R.C	Size	R.C	Size	R.C	Size	R.C
0.1											4×5.4	1				
0.22											4×5.4	3				
0.33											4×5.4	4				
0.47											4×5.4	5				
1											4×5.4	8	4×5.4	8		
2.2											4×5.4	12	4×5.4	12		
3.3											4×5.4	14	5×5.4	17		
4.7									4×5.4	17	5×5.4	20	6.3×5.4	22		
10					4×5.4	20	4×5.4	20	5×5.4	27	6.3×5.4	32	6.3×5.4	32		
22	4×5.4	22	4×5.4	22	5×5.4	30	5×5.4	30	6.3×5.4	44	6.3×5.4	38	6.3×7.7	58	8×10.2	100
33	4×5.4	34	5×5.4	34	5×5.4	34	6.3×5.4	46	6.3×5.4	46	6.3×7.7	65	8×10.2	140	10×10.2	150
47	5×5.4	38	5×5.4	38	6.3×5.4	48	6.3×5.4	48	6.3×7.7	80	6.3×7.7	70	8×10.2	170	10×10.2	210
100	6.3×5.4	69	6.3×5.4	69	6.3×7.7	69	6.3×7.7	100	6.3×7.7	140	8×10.2	210	10×10.2	310	12.5×13.5	380
										180						
220	6.3×7.7	120	6.3×7.7	120	6.3×7.7	120	8×10.2	270	8×10.2	270	10×10.2	330	12.5×13.5	470	16×16.5	450
330	8×10.2	290	8×10.2	290	8×10.2	290	8×10.2	290	10×10.2	486	12.5×13.5	510	16×16.5	650		
470	8×10.2	320	8×10.2	320	8×10.2	380	10×10.2	380	12.5×13.5	570	12.5×16	590	16×16.5	700		
1000	10×10.2	410	10×10.2	410	12.5×13.5	510	12.5×16	550	16×16.5	800						
2200	12.5×13.5	680	12.5×13.5	680	16×16.5	900	16×16.5	900								
3300	12.5×16	850	16×16.5	950	16×16.5	950										
4700	16×16.5	1000	16×16.5	1000												
6800	18×16.5	1290														